

ROOF DRAINAGE PLAN SCALE - 1:100

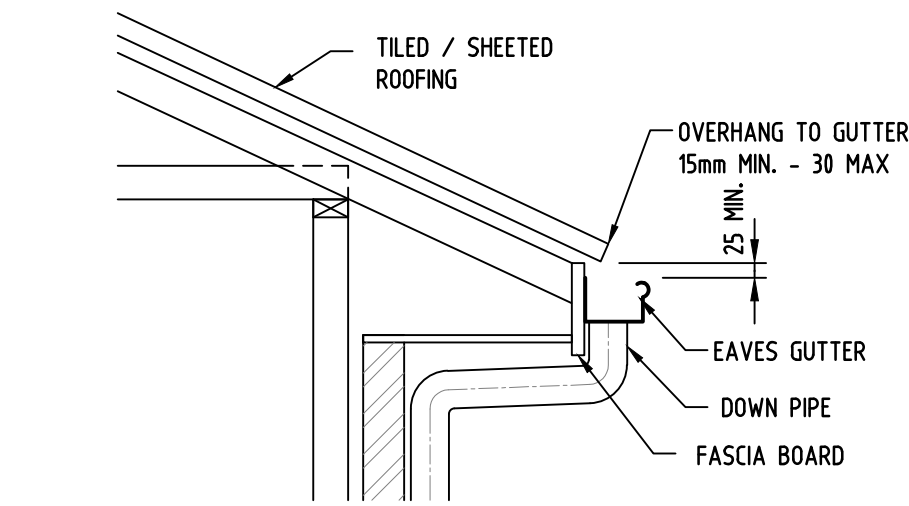

TYPICAL EAVE GUTTER DETAIL WITH LOW FRONT N.T.S.

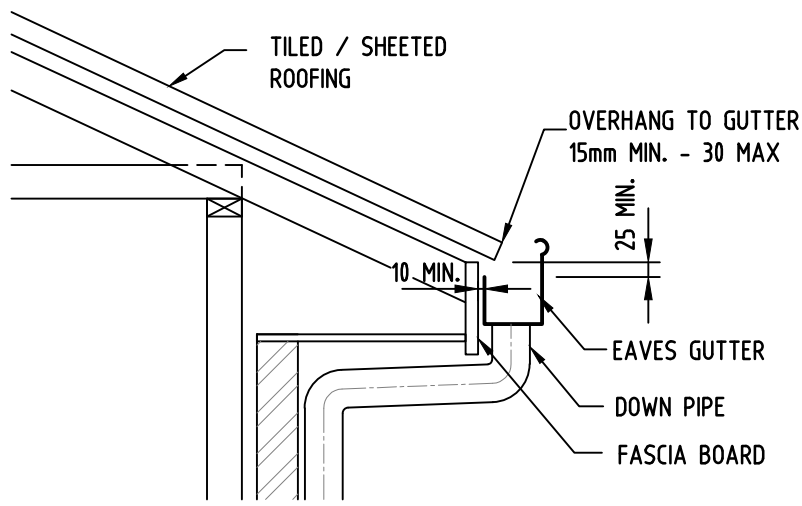

TYPICAL EAVE GUTTER DETAIL WITH HIGH FRONT & 10mm GAP TO FACIA N.T.S.

LEGEND

- RL REDUCED LEVEL
- CL COVER LEVEL
- IL INVERT LEVEL
- GSP GRATED SURFACE INLET PIT
- OSD ON-SITE DETENTION
- TWL TOP WATER LEVEL
- BWL BOTTOM WATER LEVEL
- TW TOP OF WALL
- ID/F INSPECTION OPENING
- ARI AVERAGE RECURRENCE INTERVAL
- FW FLOOR WASTE
- AHD AUSTRALIAN HEIGHT DATUM
- PSD PERMISSIBLE SITE DISCHARGE
- HED HIGH EARLY DISCHARGE
- RHS RECTANGULAR HOLLOW SECTION
- SS STAINLESS STEEL
- FRC FIBER REINFORCED CONCRETE
- RCP REINFORCED CONCRETE PIPE
- RRJ RUBBER RING JOINT
- U/S UNDERSIDE OF SLAB
- O/S OVER THE SLAB
- DP DOWN PIPE
- DROPPER
- RWO RAIN WATER OUTLET
- RWH RAIN WATER HEAD
- FFL FINISHED FLOOR LEVEL
- EX. EXISTING

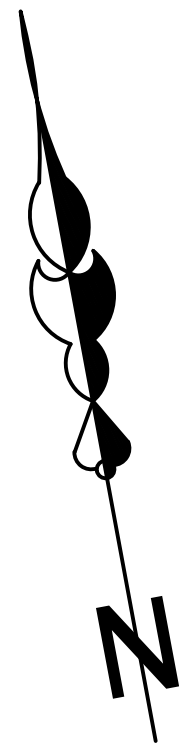

GENERAL NOTES:

- ALL SERVICES ARE TO BE LOCATED IN THE FIELD IN CONJUNCTION WITH A RESPONSIBLE OFFICER OF EACH RELEVANT AUTHORITY PRIOR TO COMMENCEMENT OF CONSTRUCTION.
- DRAINAGE PITS ARE TO BE A 450mm SQUARE OR LARGER AS SHOWN, AND FITTED WITH A GALVANIZED GRATE.
- ALL PITS ARE TO HAVE A GALVANISED GRATE AND FRAME. FRAME TO BE CAST INTEGRALLY WITH THE PIT.
- ALL PITS ARE TO BE BENCH TO HALF PIPE LEVEL.
- PROVIDE STEP IRONS WHERE PIT IS DEEPER THAN 1m. AT 450mm CENTERS.
- DRAINAGE PIPES SHALL BE SEWER GRADE UPVC UNLESS OTHERWISE NOTED.
- DRAINAGE PIPE SIZES ARE 100mm DIAMETER UNLESS OTHERWISE NOTED.
- ALL BARE SOIL AREAS ARE TO BE PROTECTED FROM EROSION BY TEMPORARY MEASURES AND REVEGETATED AT THE CESSATION OF CONSTRUCTION.
- THE DOWNHILL BOUNDARY OF THE SITE IS TO BE PROTECTED BY HAY BALES OR A FILTER FABRIC FENCE DURING CONSTRUCTION AS SHOWN IN THE ATTACHED DETAILS.
- THE STREET DRAINAGE PIT LOCATED DOWNHILL OF THE SITE SHALL BE PROTECTED FROM SEDIMENT WITH SEDIMENT BARRIER.
- A SINGLE CONSTRUCTION ENTRANCE SHALL BE ESTABLISHED IN THE MANNER SHOWN IN THE ATTACHED DETAILS.
- THIS DRAWING SHALL BE READ IN CONJUNCTION WITH ARCHITECTURAL AND STRUCTURAL ENGINEERING DOCUMENTS. ANY DISCREPANCIES SHALL BE REPORTED BY THE BUILDER TO THE ARCHITECT PRIOR TO COMMENCEMENT OF THE ITEM.
- THESE PLANS ARE DIAGRAMMATIC AND SHOW THE GENERAL LOCATION OF STRUCTURES AND PIPES. WORK SHALL BE SET OUT ON SITE BY THE SITE FOREMAN & MAY VARY FROM THE PLANS TO THE EXTENT REQUIRED TO ENSURE COMPATIBLE CONSTRUCTION OF OTHER SERVICES AND STRUCTURAL REQUIREMENTS. VARIATION IN LOCATION OF MORE THAN 1.0M & ANY CHANGES IN SIZE OF ANY COMPONENT NOMINATED HEREON SHALL BE REFERRED TO THE DESIGNER FOR COMMENT.
- IF IN DOUBT, ASK THE SUPERINTENDENT WHO SHALL CONSULT THE DESIGNER.

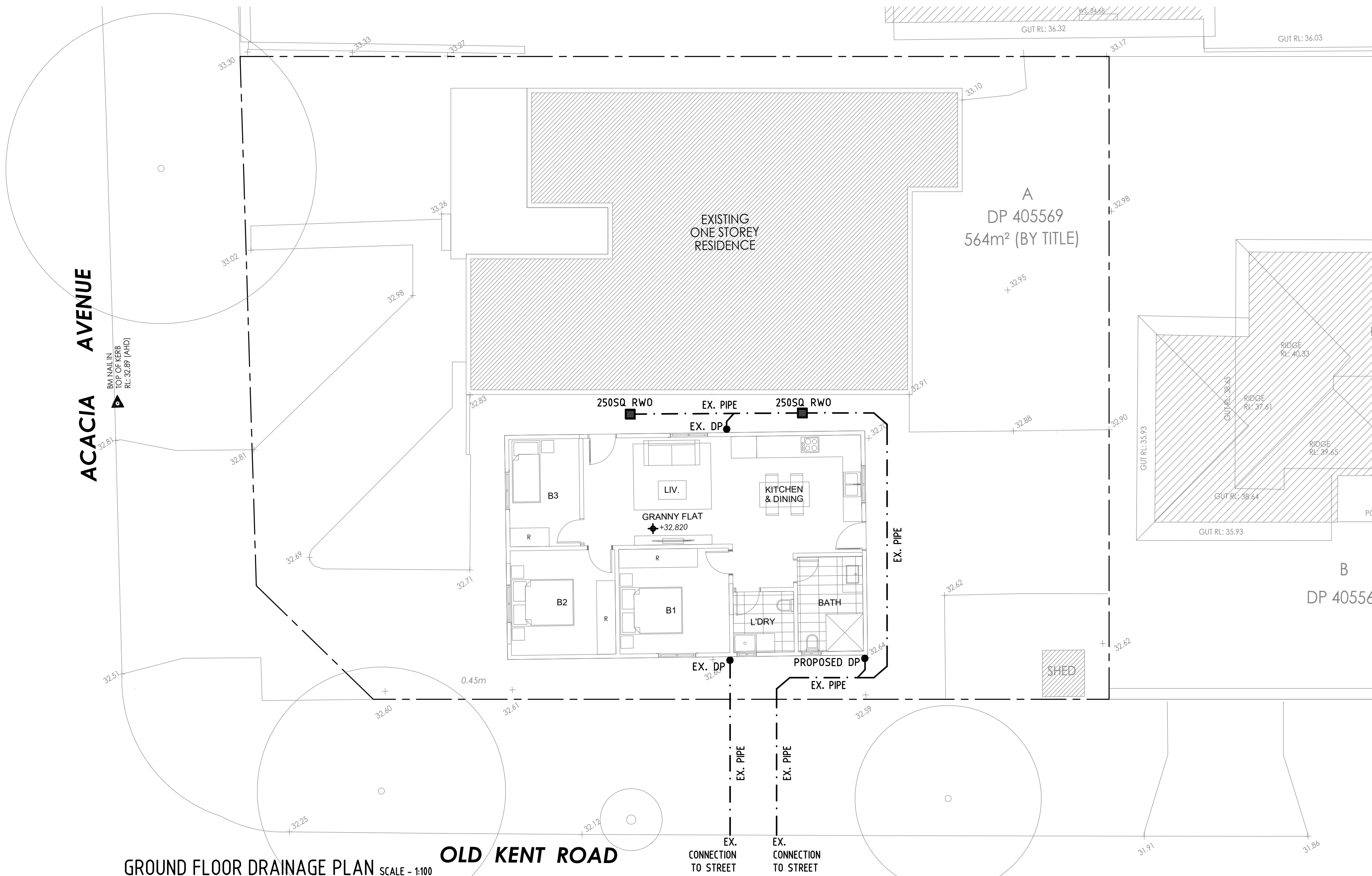

GROUND FLOOR DRAINAGE PLAN SCALE - 1:100

- * DENOTES PROPOSED LEVEL
- × DENOTES EXISTING LEVEL
- DENOTES DOWNPIPE
- · — PROPOSED STORMWATER PIPE

NOT FOR CONSTRUCTION

A	29.07.2021	ISSUED TO THE ARCHITECT	JDR
REV.	DATE	AMENDMENT DESCRIPTION	DRAWN
<div><div></div><div><div>JOHN ROMANOUS & ASSOCIATES</div><div>PTY. LTD.</div><div>CONSULTING CIVIL & STRUCTURAL ENGINEERS</div><div>ACN 054 595 005</div><div>SUITE 2D / 322 KINGSGROVE RD, KINGSGROVE NSW 2208 Ph (02) 83 87 68 26</div></div></div>			
PROPOSED DEVELOPMENT AT: 109 ACACIA AVENUE, GREENACRE.			
STORMWATER DRAINAGE / SEDIMENT CONTROL DETAILS			
DRAWN	CHECKED	SCALE	DATUM
JDR	D.M.ROMANOUS ,B.E., M.J.E.AUST.	AS SHOWN @A1	A.H.D
DRAWING No.		REV.	
2247 - S1/1		A	